

GUC Series

Note: Verify that the structural gap is in conformance with submittal data before beginning installation. If this is a Fire Rated Assembly, the first barrier must be installed before the Architectural Joint System. Refer to the fire barrier instructions for specific system installation.

Fig. 1

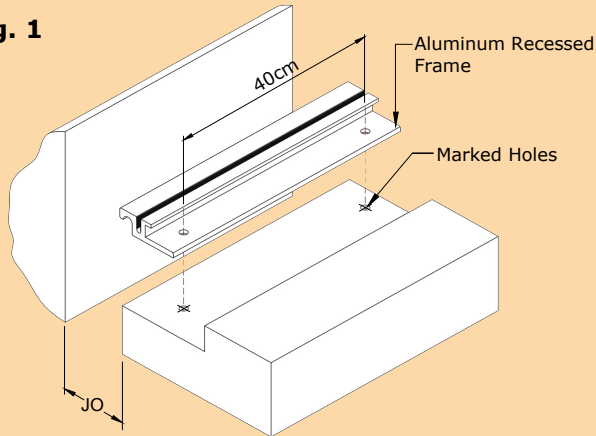

Fig. 1a

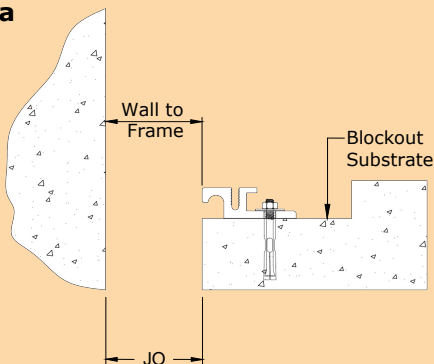
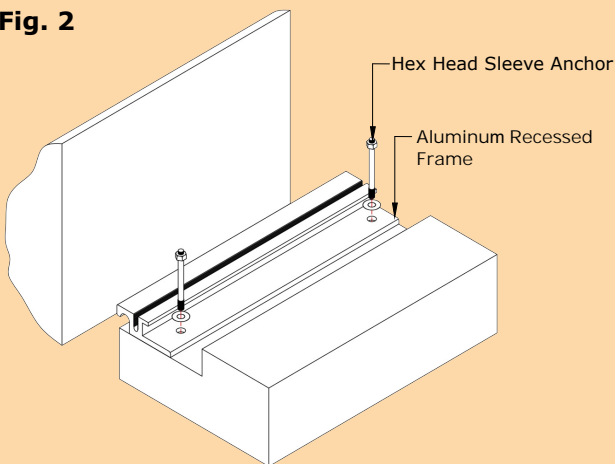

Fig. 2



1. Install the architectural joint system on a level surface within the blockout. Make sure the top surface of the cover plate is level with the floor finished.
2. Cut the aluminum components to length as needed.

Figure 1

3. Align the frame within the blockout, ensuring the frame bases do not extend over the structural gap.
4. To properly space frame to wall, use the chart below to determine the distance between the wall and the opposing outside face of the frame measured at the top (see figure 1a).

Joint Opening (mm)	Wall to Frame (mm)
50	48
75	73
100	98
150	148
200	193
250	243
300	293

5. Drill holes on the aluminum profiles as required on site with a maximum 40cm c/c interval. Copy the pre-drilled holes in the recessed frame and mark on the concrete substrate. Then Remove the frame.
6. Drill holes in the blockout substrate using a 8mm concrete drill bit to 60-70mm depth.

Figure 2

7. Return the frame into position over the drilled holes and secure using 8mm x 60-70mm Hex head concrete sleeve anchors.

Fig. 3

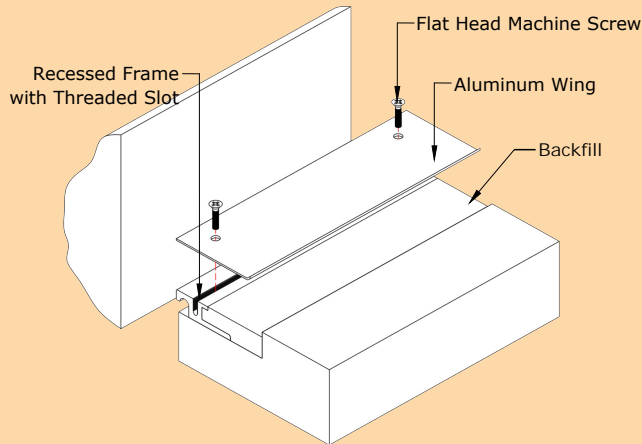

Fig. 4

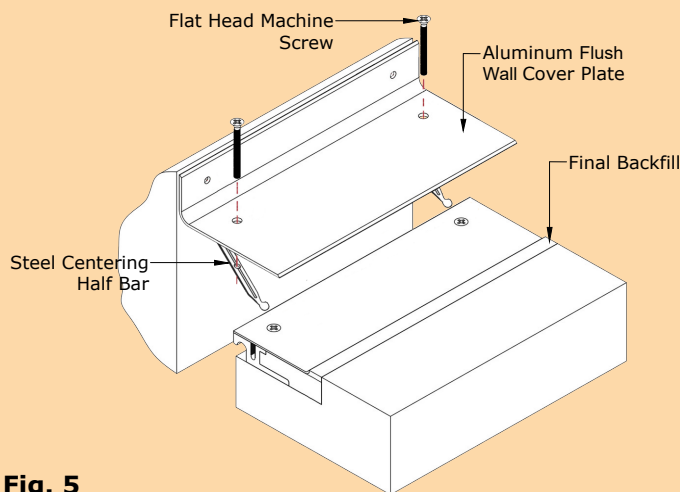

Fig. 5

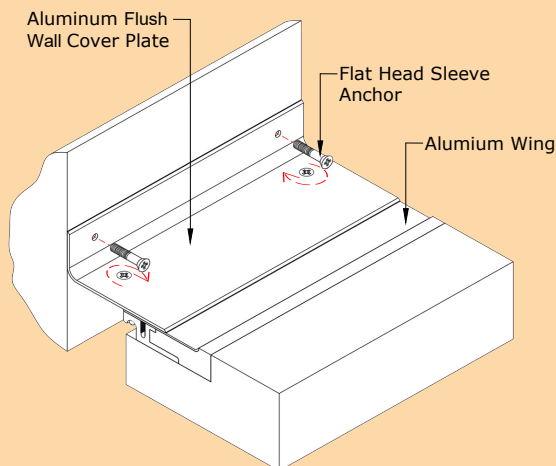

Figure 3

8. Fill the blockout up to the top level of the frame. Do not fill beyond the frame.
9. Place the aluminum wing with the pre-drilled holes and align over the threaded slot in the frame below. Secure using 1/4 x 5/8" flat head machine screws.

Figure 4

10. Complete the backfilling. Keep the level to floor finished.
11. Insert flat head machine screws into pre-drilled countersunk holes in the aluminum flush wall cover plate. Thread centering half bar loosely onto each screw with rounded domes facing upward to the cover plate.

Figure 5

12. Place the flush wall cover plate assembly onto the frame and center over the structural gap with all the centering half bars running parallel along the joint. Preferably by hand, SLOWLY tighten each screw, which will rotate the centering half bar towards the frame channel. As the screw draws the centering half bar towards the plate, the buttons on each end of the centering half bar will engage inside the radius channel of the frame.
13. Secure the corner cover plate against the wall using 8mm x 60-70mm Flat head concrete sleeve anchors.

Figure 6

14. For completion of installation, clean the exposed surfaces with non-solvent cleaner as required.

