

## DHC Series

Note: Verify that the structural gap is in conformance with submittal data before beginning installation. If this is a Fire Rated Assembly, the first barrier must be installed before the Architectural Joint System. Refer to the fire barrier instructions for specific system installation.

**Fig. 1**

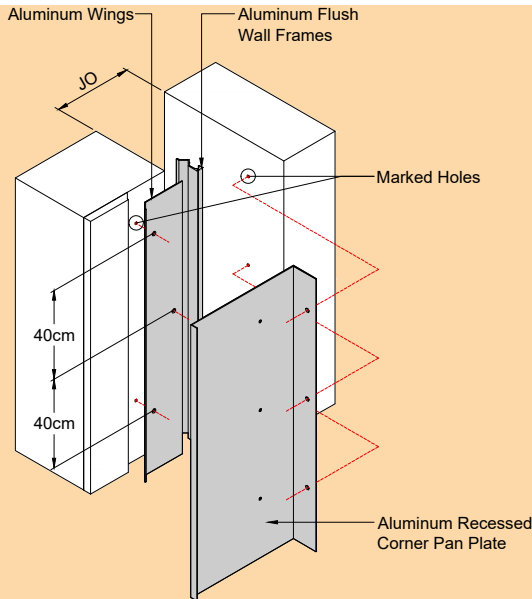

**Fig. 2**

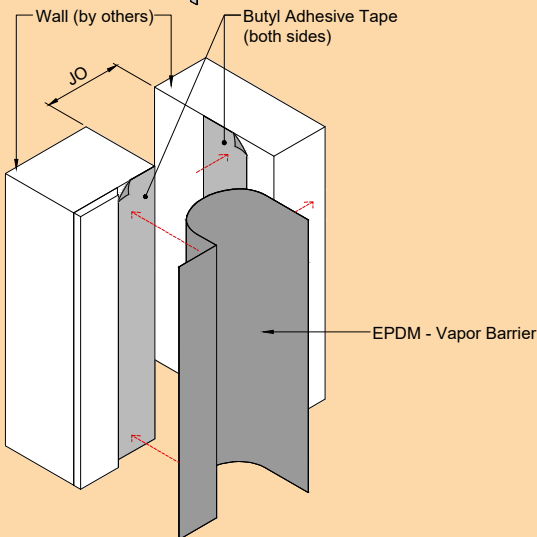

**Fig. 3**

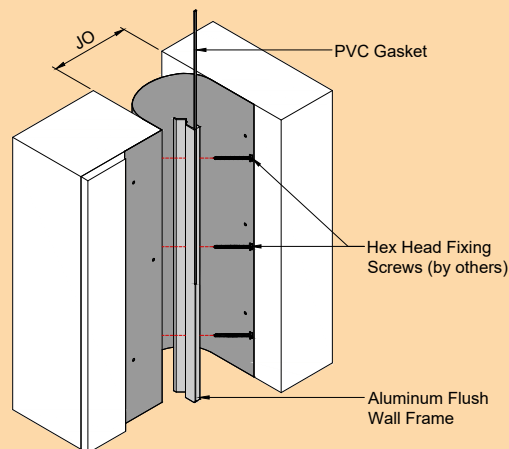

1. Install the architectural joint system on a level surface finished wall within the blockout. Make sure the top surface is level with the top of the Wall finished.
2. Cut the aluminum components to length as needed.
3. Drill holes on the aluminum profiles as required on site with a maximum 40cm c/c interval.

**Figure 1: Substrate Preparation**

4. Setup the wing, flush wall frame, flush wall corner pan plate on the substrate as a template and mark the pre-drilled holes at the maximum 40cm c/c interval. Remove the profiles.

5. Drill marked holes using a drill bit.

**Figure 2: Vapor Barrier Installation**

6. Apply butyl adhesive tape on each side of the substrate prior to the installation of the vapor barrier.
7. Place the EPDM vapor barrier within the butyl adhesive tape on the substrate without stretching and allow it to curve downwards to form a "U" shape.

**Figure 3: Flush Wall Frame Installation**

8. Position and secure the aluminum flush wall frame on the installed EPDM vapor barrier and secure in place using M6 x 60-70mm hex head fixing screws.
9. Insert the PVC Gasket into the aluminum flush wall frame mounting channel.

**Fig. 4**

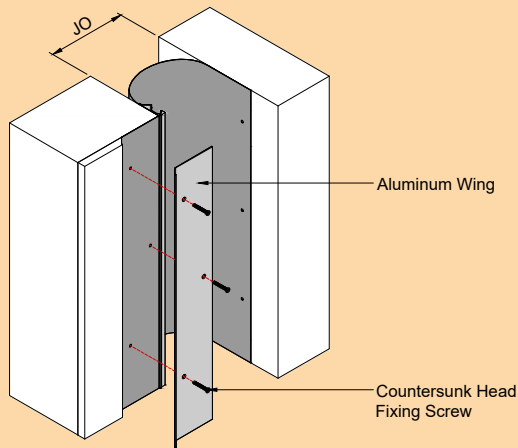
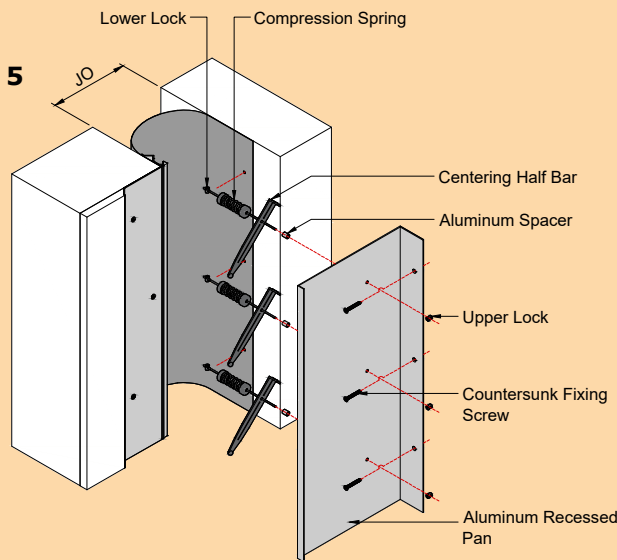

**Figure 4: Wing Installation**

10. Place the aluminum wing on top surface of the installed EPDM vapor barrier and secure in place using M6 x 50-60mm countersunk head fixing screws.

**Note:** Wing-fixing screws in a zigzag pattern start from 250mm to 600mm gap size.

**Fig. 5**

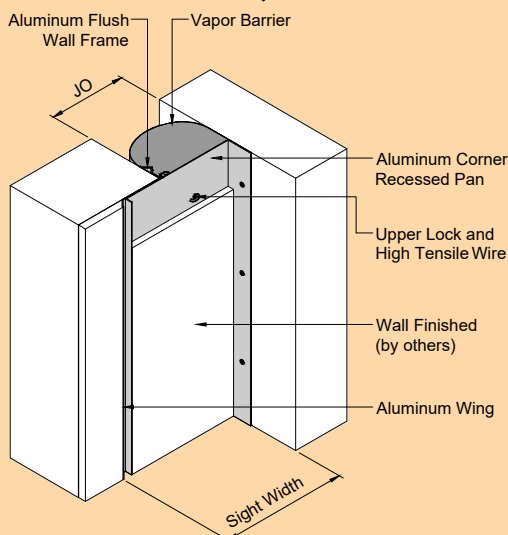

**Figure 5: Recessed Corner Pan Installation**

11. Assemble the recessed corner pan plate by inserting the high tensile wire through the pre-drilled hole, aluminum spacer, centering bar one in each wire with the rounded domes facing upward, compression spring and loosely tighten the lower and upper lock.

12. Place the corner pan plate assembly firmly against the wall corner over the installed vapor barrier and lay on the profile wing, then secure using an M6 x 50-60mm countersunk head screw. The centering half bars should be aligned diagonally and parallel to each other. Pull-up the wire and set the upper lock properly in place and tighten to engage the centering half bars underneath the mounting frame channel.

**Fig. 6**



**Figure 6: Wall Finish Installation**

13. Install the wall finish, level up to the top exposed angle of the pan plate, wing and wall finished.

14. For completion of installation, clean the exposed surfaces with non-solvent cleaner as required.