

# EEX-050 SYSTEM

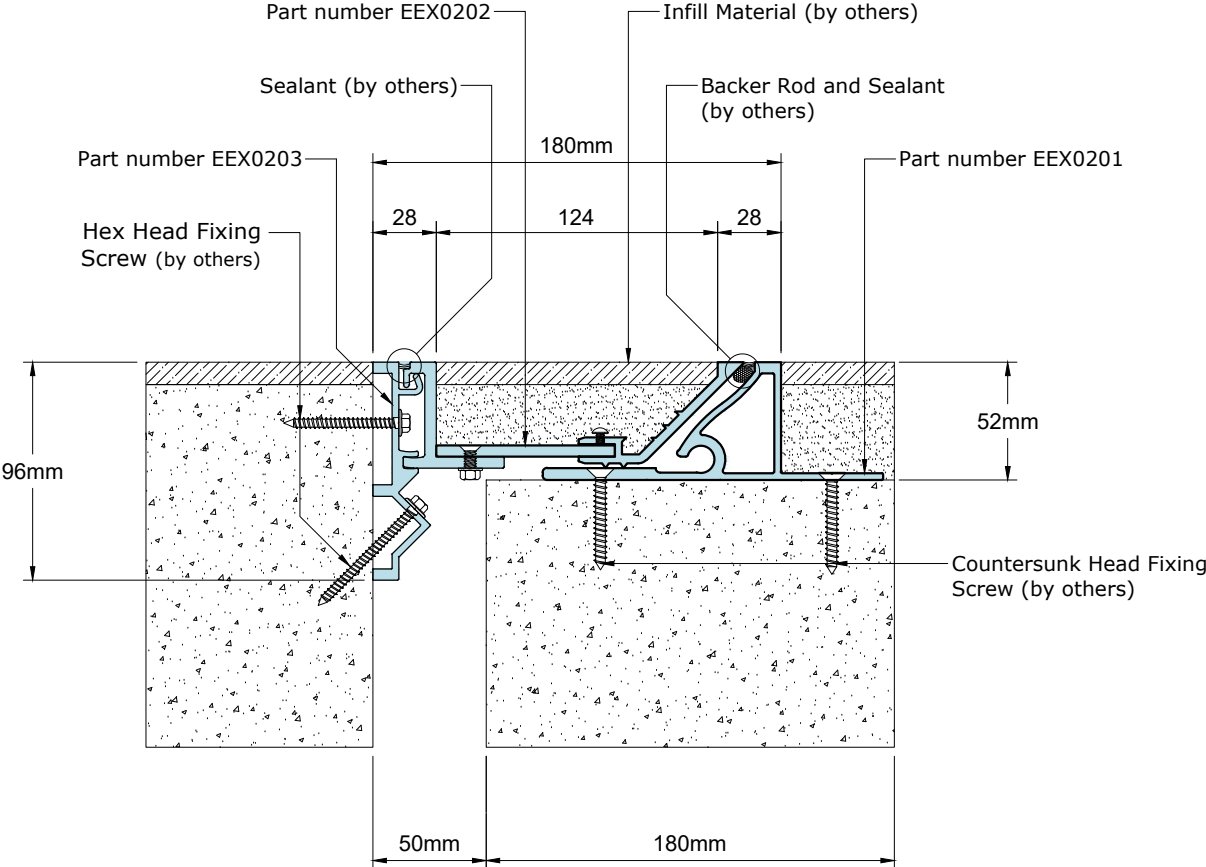

### Technical Data

Joint Width	50mm
Movement (Expansion)	50%
Movement (Contraction)	50%
Movement (Shear)	Excellent
Load	3 Tons

Date: 21-05-2026	Scale: NTS
Rev: 01	Drawn by: JOE

Application:  
Expansion Joint Cover for Floor to Floor Condition



**PROSPEC SPECIALTIES INC.**  
100-1075 North Service Rd. W,  
Oakville On L6M2G2,  
Canada  
Tel : (888) - 749 - 8456  
Email: info@prospecspecialties.com  
Web : prospecspecialties.com

**Disclaimer:** As Prospec Specialties' Policy is one of continual technical progress for the improvement of the company's services to its customers, the company reserves the right to modify the Designs of its products without notice.

# EEX-075 SYSTEM

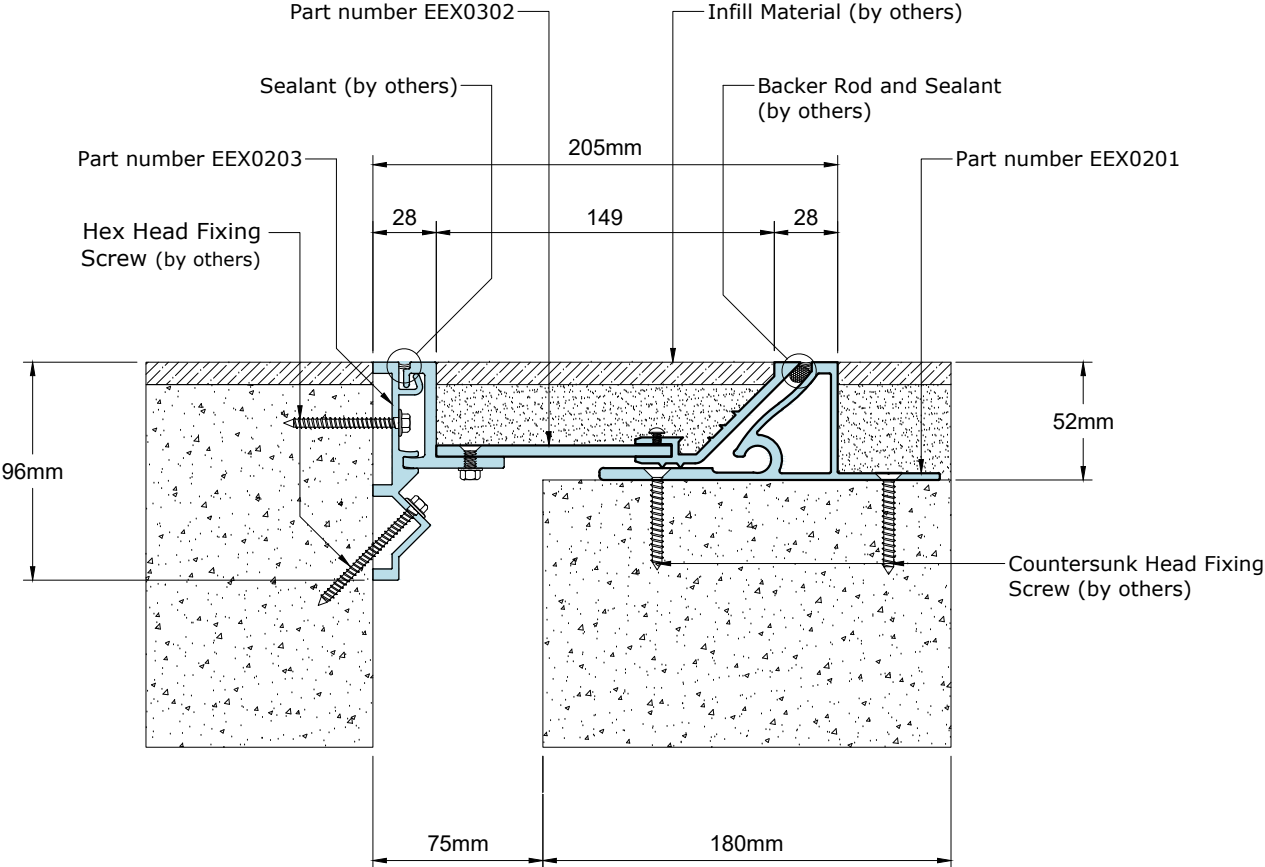

### Technical Data

Joint Width	75mm
Movement (Expansion)	50%
Movement (Contraction)	50%
Movement (Shear)	Excellent
Load	2 Tons

Date: 21-05-2026	Scale: NTS
Rev: 01	Drawn by: JOE

Application:  
Expansion Joint Cover for Floor  
to Floor Condition



**PROSPEC SPECIALTIES INC.**  
100-1075 North Service Rd. W,  
Oakville On L6M2G2,  
Canada  
Tel : (888) - 749 - 8456  
Email: info@prospecspecialties.com  
Web : prospecspecialties.com

**Disclaimer:** As Prospec Specialties' Policy is one of continual technical progress for the improvement of the company's services to its customers, the company reserves the right to modify the Designs of its products without notice.

# EEX-100 SYSTEM

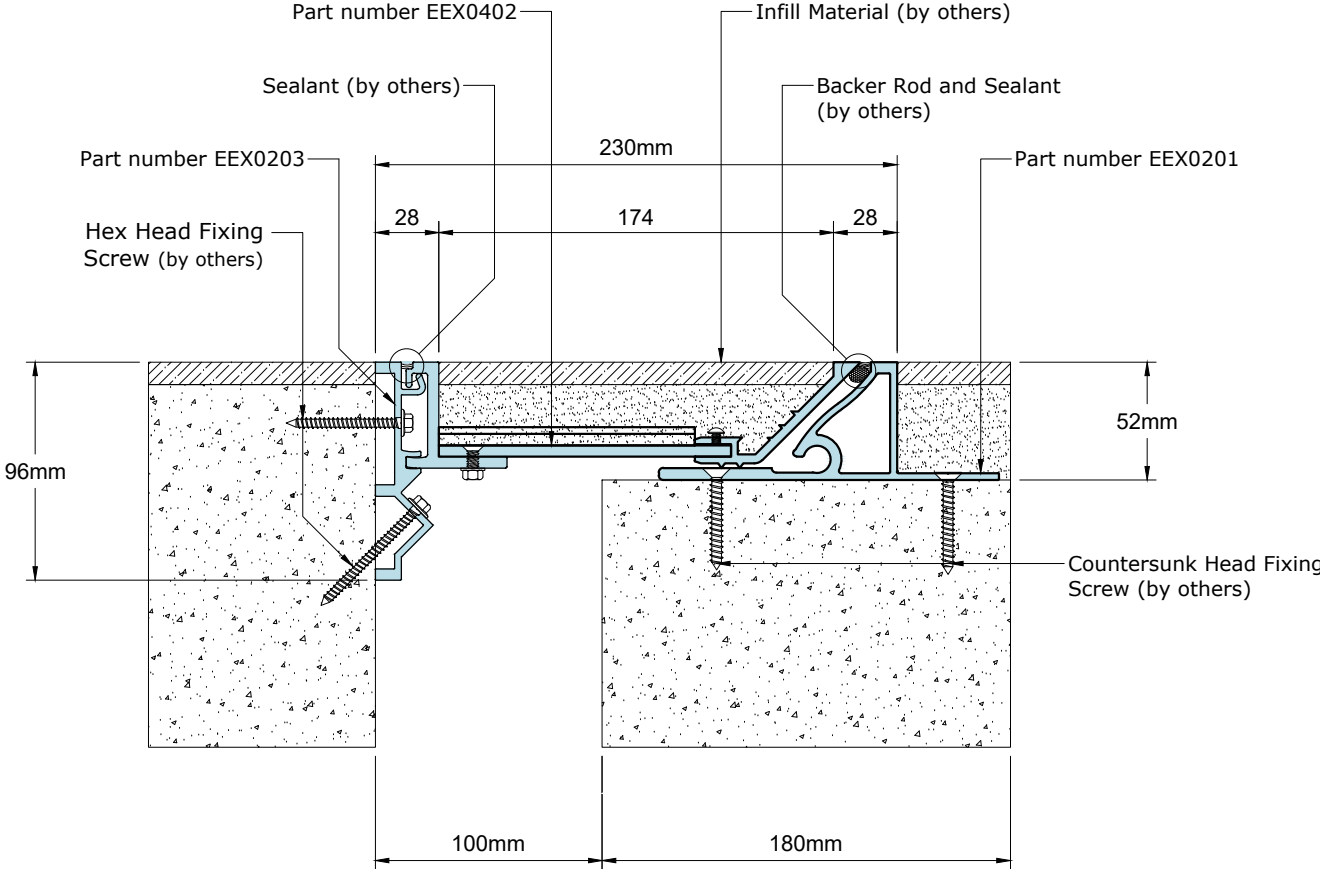

Technical Data	
Joint Width	100mm
Movement (Expansion)	50%
Movement (Contraction)	50%
Movement (Shear)	Excellent
Load	2 Tons
Date: 21-05-2026	Scale: NTS
Rev: 01	Drawn by: JOE

Application:  
Expansion Joint Cover for Floor  
to Floor Condition



**PROSPEC SPECIALTIES INC.**  
100-1075 North Service Rd. W,  
Oakville On L6M2G2,  
Canada  
Tel : (888) - 749 - 8456  
Email: info@prospecspecialties.com  
Web : prospecspecialties.com

**Disclaimer:** As Prospec Specialties' Policy is one of continual technical progress for the improvement of the company's services to its customers, the company reserves the right to modify the Designs of its products without notice.

# EEX-150 SYSTEM

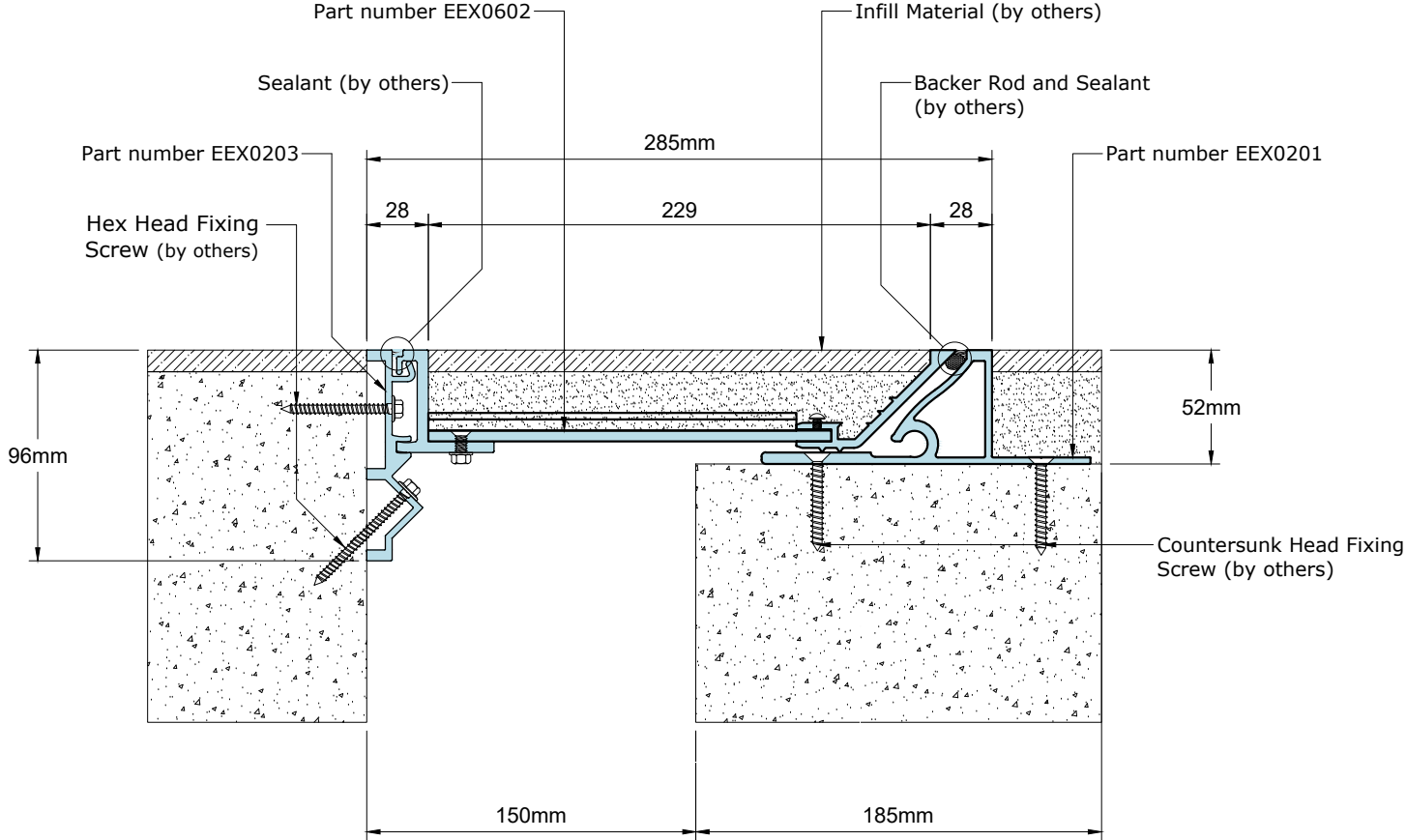

Technical Data	
Joint Width	150mm
Movement (Expansion)	50%
Movement (Contraction)	50%
Movement (Shear)	Excellent
Load	1 Tons
Date: 21-05-2026	Scale: NTS
Rev: 01	Drawn by: JOE

Application:  
Expansion Joint Cover for Floor  
to Floor Condition



**PROSPEC SPECIALTIES INC.**  
100-1075 North Service Rd. W,  
Oakville On L6M2G2,  
Canada  
Tel : (888) - 749 - 8456  
Email: info@prospecspecialties.com  
Web : prospecspecialties.com

**Disclaimer:** As Prospec Specialties' Policy is one of continual technical progress for the improvement of the company's services to its customers, the company reserves the right to modify the Designs of its products without notice.

# EEX-200 SYSTEM

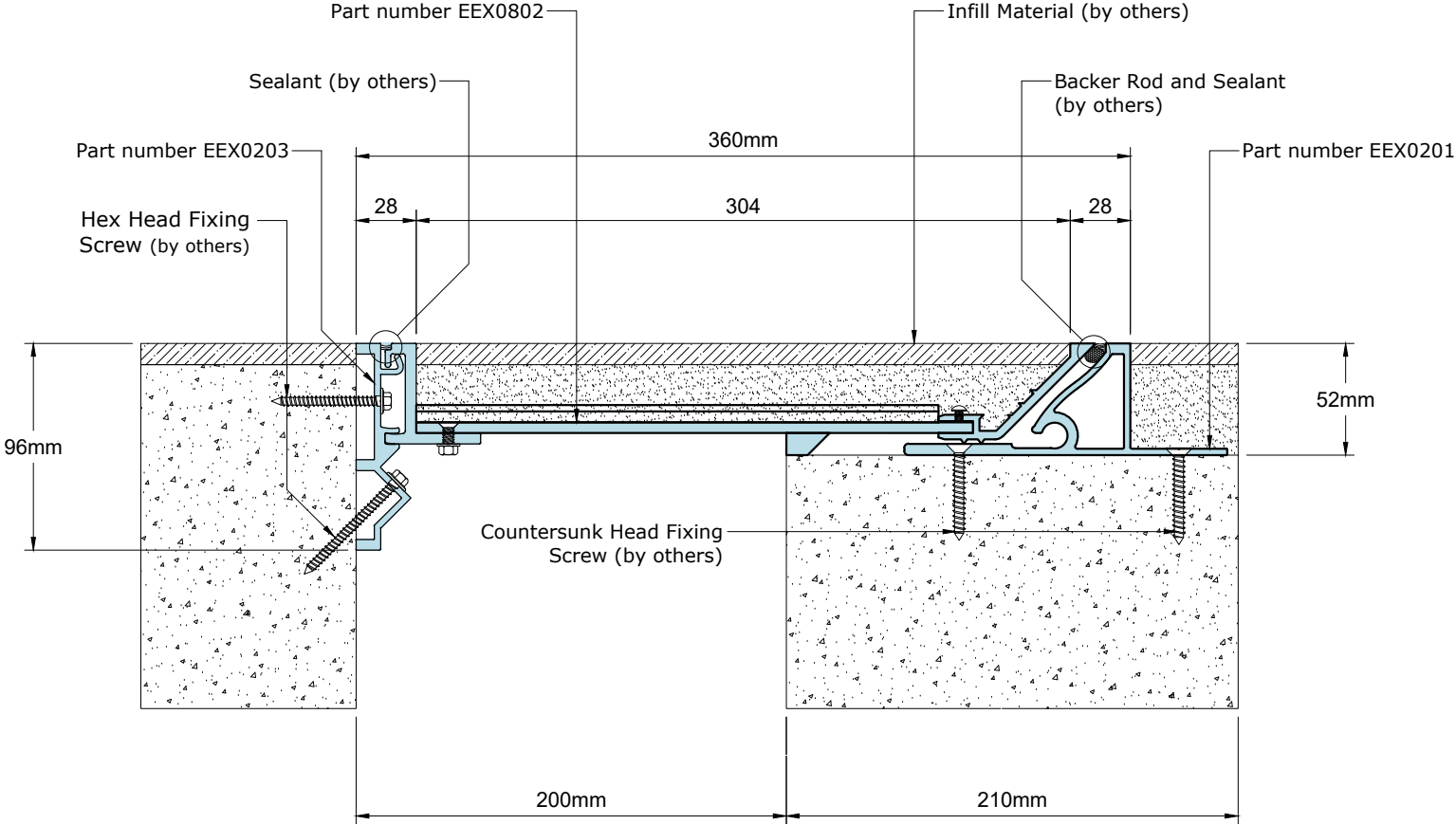

### Technical Data

Joint Width	200mm
Movement (Expansion)	50%
Movement (Contraction)	50%
Movement (Shear)	Excellent
Load	1 Tons

Date: 21-05-2026	Scale: NTS
Rev: 01	Drawn by: JOE

Application:  
Expansion Joint Cover for Floor to Floor Condition



**PROSPEC SPECIALTIES INC.**  
 100-1075 North Service Rd. W,  
 Oakville On L6M2G2,  
 Canada  
 Tel : (888) - 749 - 8456  
 Email: info@prospecspecialties.com  
 Web : prospecspecialties.com

**Disclaimer:** As Prospec Specialties' Policy is one of continual technical progress for the improvement of the company's services to its customers, the company reserves the right to modify the Designs of its products without notice.

# EEX-250 SYSTEM

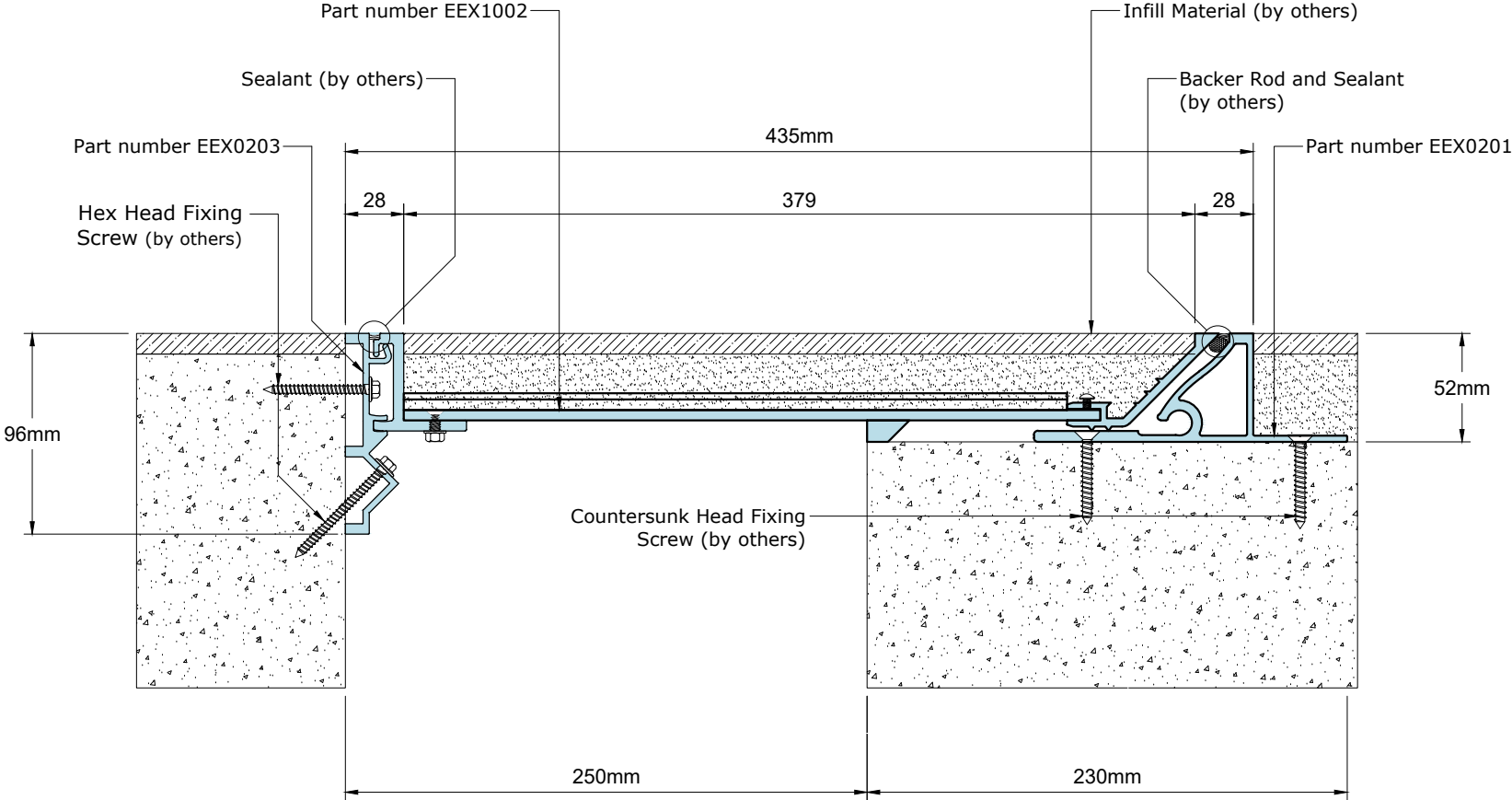

### Technical Data

Joint Width	250mm
Movement (Expansion)	50%
Movement (Contraction)	50%
Movement (Shear)	Excellent
Load	1 Tons

Date: 21-05-2026	Scale: NTS
Rev: 01	Drawn by: JOE

Application:  
Expansion Joint Cover for Floor  
to Floor Condition



**PROSPEC SPECIALTIES INC.**  
100-1075 North Service Rd. W,  
Oakville On L6M2G2,  
Canada  
Tel : (888) - 749 - 8456  
Email: info@prospecspecialties.com  
Web : prospecspecialties.com

**Disclaimer:** As Prospec Specialties' Policy is one of continual technical progress for the improvement of the company's services to its customers, the company reserves the right to modify the Designs of its products without notice.

# EEX-300 SYSTEM

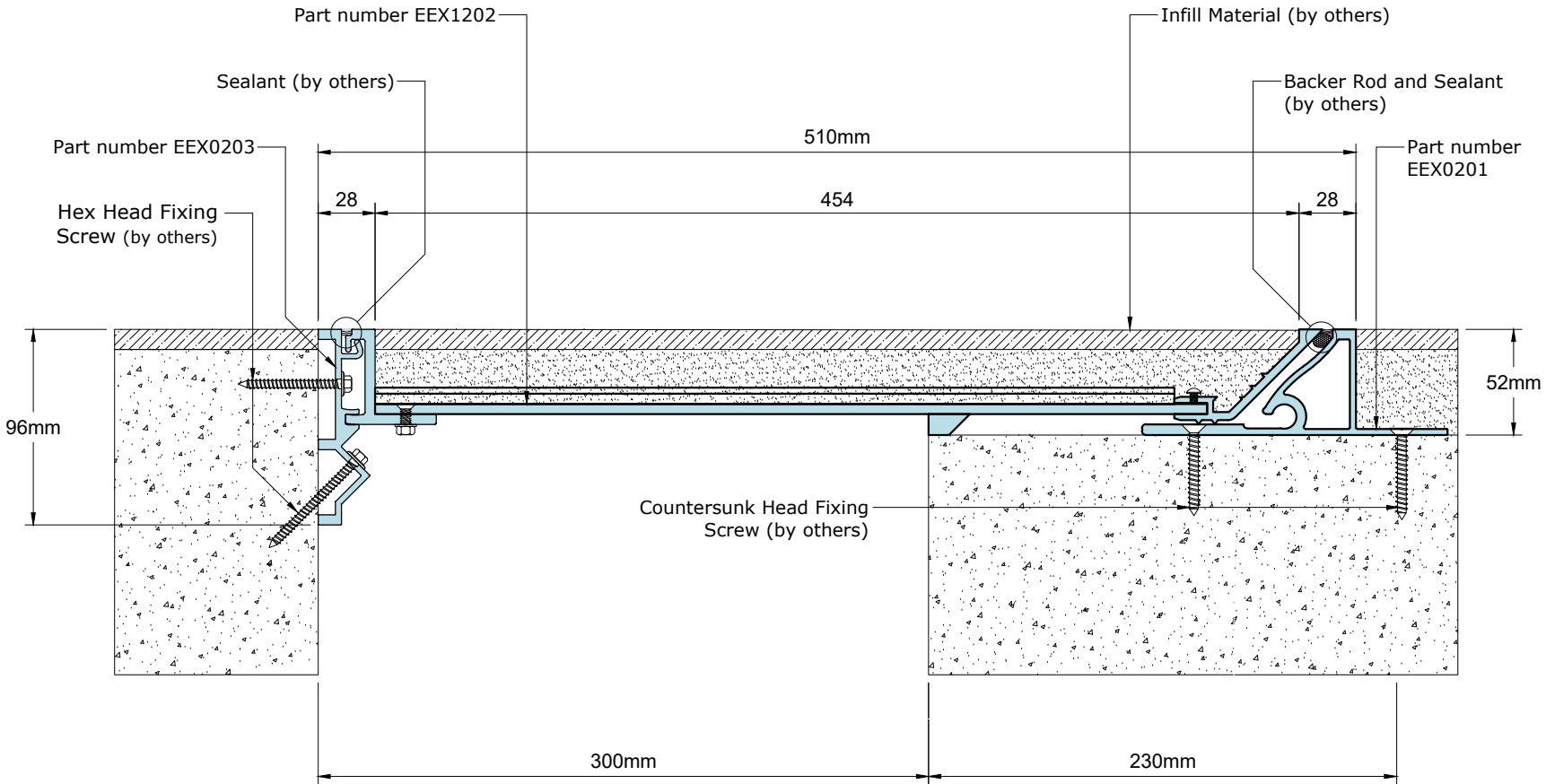

### Technical Data

Joint Width	300mm
Movement (Expansion)	50%
Movement (Contraction)	50%
Movement (Shear)	Excellent
Load	1 Tons

Date: 21-05-2026	Scale: NTS
Rev: 01	Drawn by: JOE

Application:  
Expansion Joint Cover for Floor to Floor Condition



**PROSPEC SPECIALTIES INC.**  
 100-1075 North Service Rd. W,  
 Oakville On L6M2G2,  
 Canada  
 Tel : (888) - 749 - 8456  
 Email: info@prospecspecialties.com  
 Web : prospecspecialties.com

**Disclaimer:** As Prospec Specialties' Policy is one of continual technical progress for the improvement of the company's services to its customers, the company reserves the right to modify the Designs of its products without notice.