

DHS Series

Note: Verify that the structural gap is in conformance with submittal data before beginning installation. If this is a Fire Rated Assembly, the first barrier must be installed before the Architectural Joint System. Refer to the fire barrier instructions for specific system installation.

Fig. 1

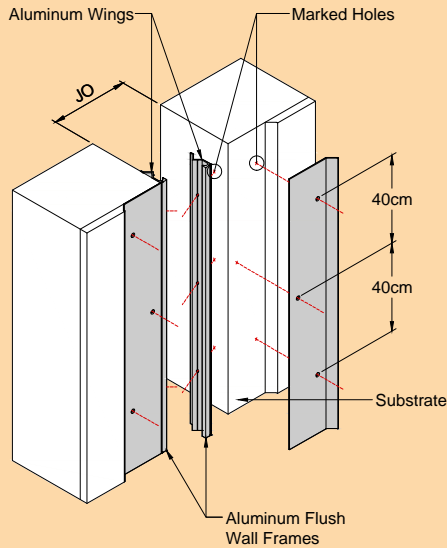

1. Install the architectural joint system on a level surface finished wall within the blockout. Make sure the top surface is level with the top of the Wall finished.
2. Cut the aluminum components to length as needed.
3. Drill holes on the aluminum profiles as required on site with a maximum 40cm c/c interval.

Figure 1: Substrate Preparation

Fig. 2

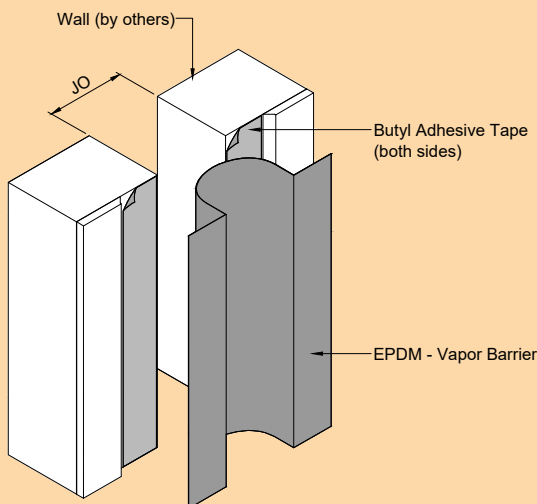

4. Setup the wings and flush wall frames on the substrate as a template and mark the pre-drilled holes at the maximum 40cm c/c interval. Remove the frame.
5. Drill marked holes using a drill bit.

Figure 2: Vapor Barrier Installation

Fig. 3

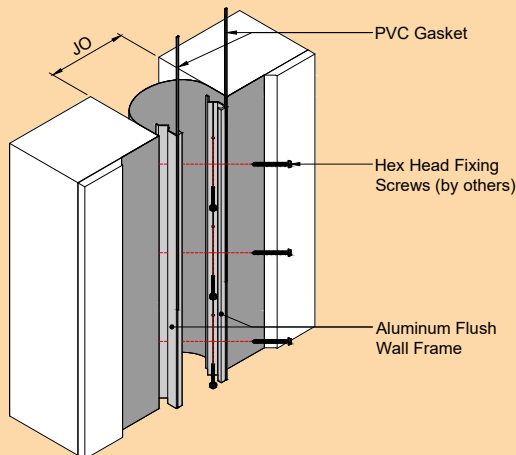

6. Apply butyl adhesive tape on both sides of the substrate prior to the installation of the vapor barrier.
7. Place the EPDM vapor barrier within the butyl adhesive tape on the substrate without stretching and allow it to curve downwards to form a "U" shape.

Figure 3: Flush Wall Frame Installation

8. Position and secure the aluminum flush wall frame on both sides of the installed EPDM vapor barrier and secure in place using M6 x 60-70mm hex head fixing screws.
9. Insert the PVC Gasket into the aluminum flush wall frame mounting channel.



Fig. 4

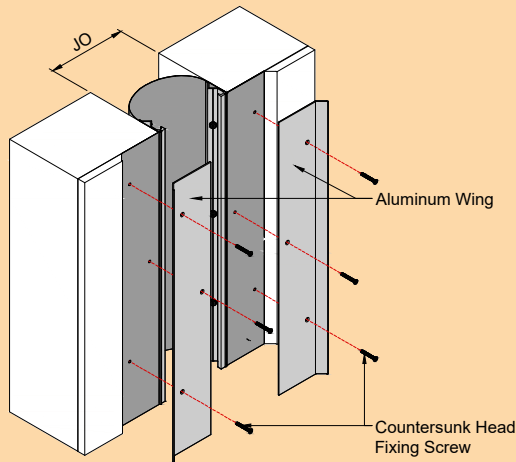

Figure 4: Wings Installation

10. Place the aluminum wing on both sides top surface of the installed EPDM vapor barrier and secure in place using M6 x 50-60mm countersunk head fixing screws.

Note: Wing-fixing screws in a zigzag pattern start from 250mm to 600mm gap size.

Fig. 5

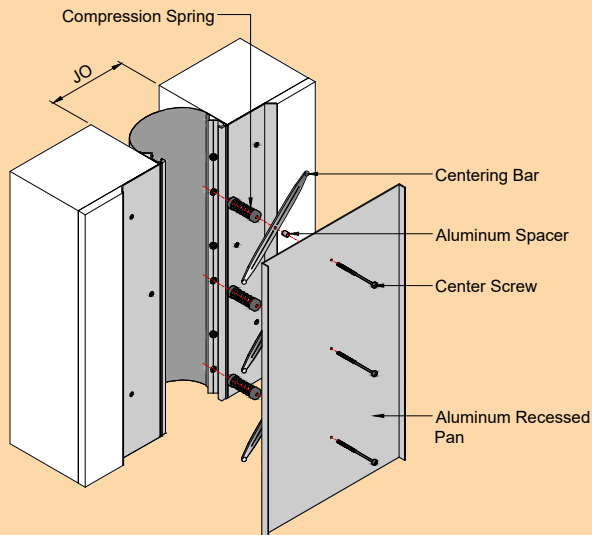

Figure 5: Recessed Center Pan Installation

11. Assemble the recessed center pan plate by inserting the center screw through the pre-drilled hole, aluminum spacer, centering bar by loosely threading one in each screw with the rounded domes facing upward and compression spring with a nut.

12. Place the center pan plate assembly centered between over the wings. The centering bars should be aligned diagonally and parallel to each other. Tighten the screws to engage the centering bars underneath the mounting frame channels.

Fig. 6

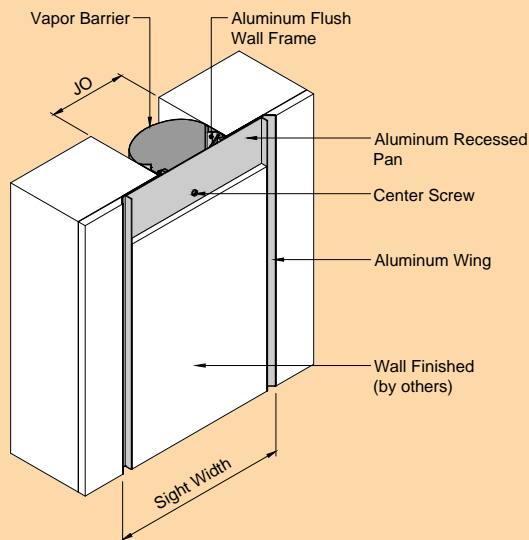

Figure 6: Wall Finish Installation

13. Install the wall finish, level up to the top exposed angle of the pan plate, wings and wall finished.

14. For completion of installation, clean the exposed surfaces with non-solvent cleaner as required.

